

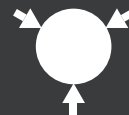

HARTE SPEZIALAUFSATZBACKEN

HARD TOP SPECIAL JAWS



* 1 SATZ BACKEN (3 STÜCK)
* SET OF 3 JAWS

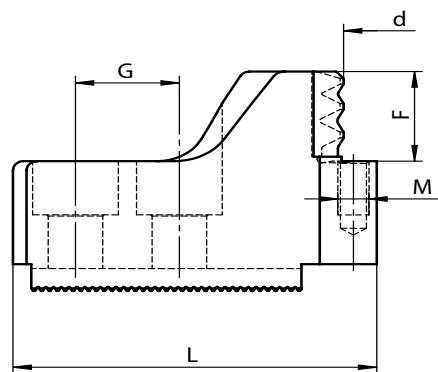
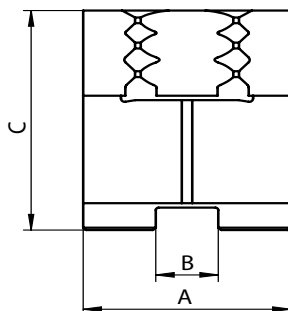

Verzahnung (1,5x60°)
Serration (1,5x60°)

Artikelnummer	Größe [mm]	Spannbereich [mm]*	A	B	C	F	G	L	M	[kg]	Für Typ
Code number	Size [mm]	Clamping range [mm]*									For type
398521609900	160	28 - 55	40	12	49	20	20	74,0	M6	1,89	2405-160-45K
398521612100	160	36 - 68	40	12	49	20	20	68,0	M6	1,72	2405-160-45K
398521613400	160	50 - 81	40	12	49	20	20	70,0	M6	1,75	2405-160-45K
398521614700	160	63 - 97	40	12	49	20	20	60,0	M6	1,46	2405-160-45K
398521615000	160	80 - 112	40	12	49	20	20	60,0	M6	1,71	2405-160-45K
398521716300	200	29 - 72	40	14	49	20	25	83,0	M6	2,04	2405-200-52K
398521714800	200	63 - 100	40	14	49	20	25	69,0	M6	1,79	2405-200-52K
398521713500	200	92 - 129	40	14	49	20	25	57,0	M6	1,50	2405-200-52K
398521717600	200	111 - 158	40	14	49	20	25	50,0	M6	1,18	2405-200-52K
398521715000	200	150 - 189	40	14	49	20	25	73,5	M6	2,00	2405-200-52K
398521722400	250	40 - 94	40	16	59	25	30	97,0	M6	2,86	2405-250-75K
398521723700	250	78 - 130	40	16	59	25	30	78,0	M6	2,18	2405-250-75K
398521724000	250	121 - 173	40	16	59	25	30	67,0	M6	2,00	2405-250-75K
398521725200	250	166 - 215	40	16	59	25	30	66,5	M6	1,95	2405-250-75K
398521726500	250	203 - 252	40	16	59	25	30	85,5	M6	2,61	2405-250-75K
398521732600	315	41 - 127	50	21	59	30	30	120,0	M8	3,96	2405-315-91K
398521733900	315	89 - 181	50	21	59	30	30	95,0	M8	3,22	2405-315-91K
398521734100	315	153 - 245	50	21	59	30	30	75,0	M8	2,43	2405-315-91K
398521735400	315	219 - 300	50	21	59	30	30	85,0	M8	3,06	2405-315-91K



Verzahnung (1/16" x 90°)
Serration (1/16" x 90°)

Artikelnummer	Größe [mm]	Spannbereich [mm]*	A	B	C	F	G	L	M	[kg]	Für Typ
Code number	Size [mm]	Clamping range [mm]*									For type
398522520500	160	28 - 55	40	17	49	20	24	74,0	M6	1,75	2405-160-45
398522521800	160	36 - 68	40	17	49	20	24	68,0	M6	1,57	2405-160-45
398522522000	160	50 - 81	40	17	49	20	24	70,0	M6	1,60	2405-160-45
398522523300	160	63 - 97	40	17	49	20	24	60,0	M6	1,32	2405-160-45
398522524600	160	80 - 112	40	17	49	20	24	60,0	M6	1,53	2405-160-45
398522530700	200	29 - 72	40	17	49	20	23	83,0	M6	2,02	2405-200-52
398522531000	200	63 - 100	40	17	49	20	23	69,0	M6	1,78	2405-200-52
398522532200	200	92 - 129	40	17	49	20	23	57,0	M6	1,47	2405-200-52
398522533500	200	111 - 158	40	17	49	20	23	50,0	M6	1,15	2405-200-52
398522534800	200	150 - 189	40	17	49	20	23	73,5	M6	2,00	2405-200-52
398522540900	250	40 - 94	40	21	59	25	30	97,0	M6	2,60	2405-250-75
398522541100	250	78 - 130	40	21	59	25	30	78,0	M6	1,89	2405-250-75
398522542400	250	121 - 173	40	21	59	25	30	67,0	M6	1,68	2405-250-75
398522543700	250	166 - 215	40	21	59	25	30	66,5	M6	1,64	2405-250-75
398522544000	250	203 - 252	40	21	59	25	30	85,5	M6	2,38	2405-250-75
398522550000	315	41 - 127	50	21	59	30	30	120,0	M8	3,96	2405-315-91
398522551300	315	89 - 181	50	21	59	30	30	95,0	M8	3,23	2405-315-91
398522552600	315	153 - 245	50	21	59	30	30	75,0	M8	2,44	2405-315-91
398522553900	315	219 - 300	50	21	59	30	30	85,0	M8	3,06	2405-315-91

* Die obige Tabelle zeigt die Spannweite für die BISON Futter. Bei der Verwendung unseres Feeders mit Backen anderer Hersteller können diese Angaben abweichen.
* The above table shows the clamping range for BISON chucks. When mounting other manufacturers jaws on chucks, the clamping range may vary.